



INSTRUCTIONS

IMPORTANT SAFEGUARDS

When using electrical equipment, basic safety precautions should always be followed including the following:

1. **READ AND FOLLOW ALL SAFETY INSTRUCTIONS**
2. For Indoor use ONLY.
3. Do not let the power cords touch hot surfaces.
4. Do not install near gas or electric heaters.
5. Use caution when servicing batteries. Battery acid can cause burns to the skin and eyes. If acid is spilled on skin or eyes, flush acid with fresh water and contact a physician immediately.
6. The equipment should be mounted in locations and at heights where unauthorized personnel will not readily subject it to tampering.
7. The use of accessory equipment not recommended by the manufacturer, may cause an unsafe condition, and will void the unit's warranty.
8. Do not use this equipment for other than its intended purpose.
9. Servicing of this equipment should be performed by qualified service personnel.
10. **SAVE THESE INSTRUCTIONS!**

INSTALLATION

Hardwired Installation:

1. Extend unswitched 24 hour AC supply of rated voltage to a junction box (supplied by others) installed in accordance with all applicable codes and standards. Leave at least 8 inches of slack wire. This circuit should NOT be energized/live at this time.
2. Open the unit by unscrewing the cover screws on the sides of the unit (Figure 1). The front cover can then be lifted up and removed.
3. Unit is supplied with universal spider knockouts and keyhole slots stamped into the back of the cabinet. Knock out the appropriate hole(s) and bring wires through the hole(s) into the cabinet.
4. Mount the unit securely into place. Do not rely on the electrical box as the only support for the unit. There are two keyhole mounting slots provided in the back of the unit for wall mounting.
5. Make proper wiring connections between the AC supply and the unit's transformer per diagram provided (Figure 4). **Insulate unused wire!** Connect ground to supplied green ground wire in accordance with local codes. Reassemble all wire connections and connectors. **CAUTION! - Failure to insulate unused wire may result in a shock hazard or unsafe condition as well as equipment failure.**
6. For large units the batteries may be shipped separately. Install batteries into the cabinet and complete the appropriate battery connections (Figure 5).
7. Uncoil the wire lead(s) from the Positive circuit board terminal (+) and connect to the positive terminal connector on the battery (Figure 2).
8. Route wires and secure in place.
9. Replace cover and secure cover screws.
10. Turn on AC line voltage supply.
11. Position lamps/heads to provide best lighting distribution by loosening head set screws to adjust angle and swivel. Manually rotate or twist head to desired position then tighten set screws to lock position.

CAUTION

This equipment is furnished with a sophisticated low voltage battery dropout circuit to protect the battery from over-discharge after it's useful output has been used. Allow 24 hours recharge time after installation or power failure for full-load testing.

OPERATION

ACDC models:

1. Sign will illuminate when supplied with power.

Figure 1

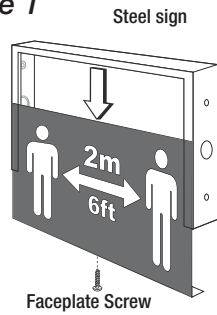

Figure 2



Figure 3

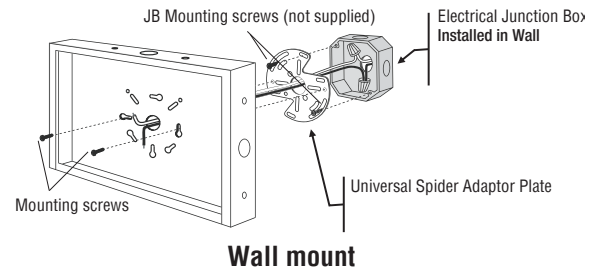
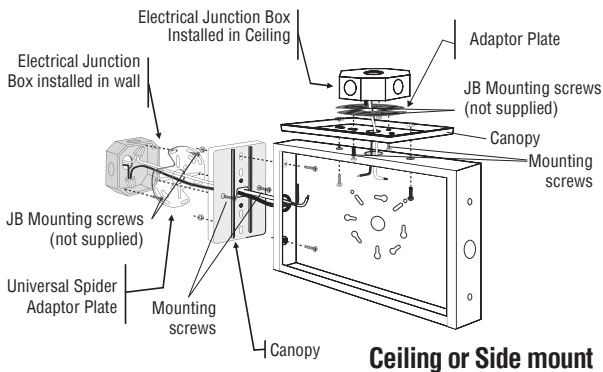

Figure 4



MAINTENANCE

- Code requires that the equipment be tested every 30 days for 30 seconds, and that written records be maintained for all test results and repairs. Further, the equipment is to be tested once a year for the required duration as per Code. The battery is to be replaced or the equipment repaired whenever the equipment fails to operate as intended during the duration test. The manufacturer strongly recommends compliance with all Code requirements.
 - Clean face(s) on a regular basis to provide maximum performance in case of an emergency.
- NOTE: The servicing of any parts should be performed by qualified service personnel only.
The use of replacement parts not furnished by the manufacturer, may cause equipment failure and will void the warranty.

TROUBLESHOOTING

SIGN DOES NOT LIGHT UP / TURN ON AT ALL

- Check the AC supply - be sure unit has 24 hour AC supply (unswitched).
- Check the AC connector. The transformer/capacitor input power assembly is connected to the LED circuit board with a plastic connector. Insure that this connector is firmly plugged into the LED circuit board. The connector will only lock into place when inserted in the correct orientation.
- Check the AC connections to transformer/capacitor assembly. Insure that the input voltage wiring matches the markings to the transformer/capacitor assembly wires being used.
- If the AC supply and connections are OK and LEDs fail to light; replace LED Board Assembly.

SIGN LEDs DO NOT LIGHT UP / TURN ON WHEN DC POWER APPLIED

- Check DC wire connections. Insure that DC input voltage wiring matches the markings on the LED board wires being used and polarity is correct.
- Insure the DC wires are firmly soldered to the LED circuit board.
- If the DC supply and connections are OK and LEDs fail to light; replace the LED circuit board.

SIGN TURNS ON DIM WHEN AC POWER IS ON

- Check the the supply voltage and AC connections. The AC supply must be at least 80% of the nominal (96V on a 120V line) for equipment to function normally. At lower voltages, the LEDs may begin to glow dimly until the source voltage drops below the full batteries turn-on point.
- Check the AC connections to the transformer/capacitor assembly. Insure that a 120 Volt supply line has not been connected to the 347 Volt transformer/capacitor lead wire.

SIGN COMES ON WHEN BATTERY IS FIRST CONNECTED (NO AC)

This is normal when the battery has enough charge to power the LEDs. The sign will remain lit until the battery is discharged.

SAVE THESE INSTRUCTIONS

BeLuce Canada Inc., 3900 14th Avenue, Unit 1, Markham, ON L3R 4R3 P: (905) 948-9500 F: (905) 948-8673

INSTRUCTIONS

IMPORTANT SAFEGUARDS

When using electrical equipment, basic safety precautions should always be followed including the following:

- 1. READ AND FOLLOW ALL SAFETY INSTRUCTIONS**
 2. Disconnect power before performing work on electrical equipment.
 3. Do not use outdoors.
 4. Use caution when servicing batteries.
 5. Equipment should be mounted in locations and at heights where unauthorized personnel will not readily subject it to tampering.
 6. The use of accessory equipment not recommended by BeLuce Canada Inc., may cause an unsafe condition, and will void the unit's warranty.
 7. Do not use this equipment for other than its intended purpose.
 8. Servicing of this equipment should be performed by qualified service personnel.
 - 9. SAVE THESE INSTRUCTIONS!**
-

INSTALLATION

WALL MOUNT - SINGLE FACE:

1. Extend unswitched 24 hour AC supply of rated voltage to junction box or appropriate wiring (supplied by others). Leave at least eight (8) inches of slack wire. The circuit should not be energized at this time.
2. Install (2) plugs into the frame to close canopy holes, push to snap into place.
3. Knock out the appropriate mounting pattern and/or wire pass-thru hole on the back plate to fit the junction box or wiring connector being used (supplied by others).
4. Bring the wires through the back of the sign and mount the sign securely in place. Screw directly to the junction box if possible.
5. Connect AC supply per diagram provided (Figure 5). **Insulate unused wire!**
CAUTION! - Failure to insulate unused wire may result in a shock hazard or unsafe condition as well as equipment failure.
6. Route wires and secure them in place.
7. Position the pictogram between the posts on the inside of the faceplate and secure with 6 push nuts. (Figure 3)
8. Install faceplate and snap into frame.
9. Turn on the AC voltage supply.

CEILING/END MOUNT - SINGLE OR DOUBLE FACE:

1. Extend unswitched 24 hour AC supply of rated voltage to junction box or appropriate wiring (supplied by others). Leave at least eight (8) inches of slack wire. The circuit should not be energized at this time.
2. Remove back plate from frame (unsnap). For double face only.
3. Feed wires through frame and through canopy (Figure 1).
3. Install canopy into frame, insert and slide sideways to engage (Figure 2).
4. Install plug into frame to close the remaining canopy hole. Push to snap into place.
5. Connect AC supply per diagram provided (Figure 5). **Insulate unused wire!**
CAUTION! - Failure to insulate unused wire may result in a shock hazard or unsafe condition as well as equipment failure.
6. Route wires and secure them in place.
7. Secure canopy to junction box.
8. Position the pictogram between the posts on the inside of the faceplate and secure with 6 push nuts. (Figure 3)
9. Install faceplate, snap into frame.
10. Turn on the AC voltage supply.

Figure 1

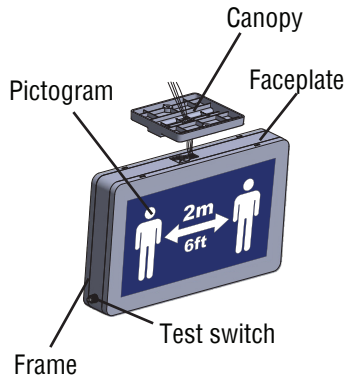

Figure 2

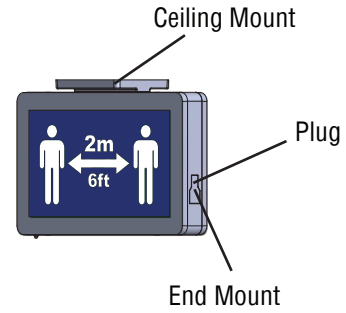

Figure 3

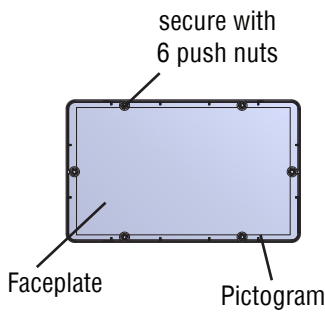
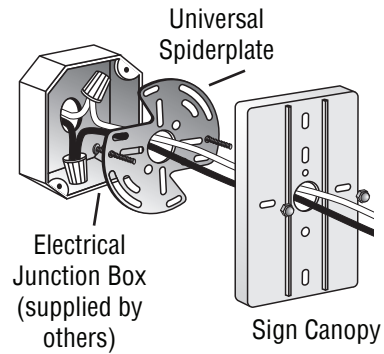

Figure 4



MAINTENANCE

- Code requires that the equipment be tested every 30 days for 30 seconds, and that written records be maintained. Further, the equipment is to be tested once a year for the duration required as per Code. The equipment is to be repaired whenever the equipment fails to operate as intended during the duration test. Written records of test results and any repairs made must be maintained. BeLuce Canada Inc. strongly recommends compliance with all Code requirements.
- Clean sign face(s) on a regular basis.

NOTE: The servicing of any parts should be performed by qualified service personnel only. The use of replacement parts not furnished by BeLuce Canada Inc., may cause equipment failure and will void the warranty.

TROUBLESHOOTING

SIGN DOES NOT COME ON AT ALL

- Check AC supply and all AC connections - be sure sign has 24 hour AC supply (unswitched).
- Check supply voltage and AC connections. The AC supply must be at least 80% of nominal (96V on a 120V line) for equipment to function normally. At lower voltages the LEDs will begin to glow dimly until the source voltage drops below the full "turn-on" point.

NOTE: This condition may also be caused by incorrectly connecting a 120 Volt supply line to the 277-Volt capacitor assembly lead.

- AC supply is OK; replace LED circuit board assembly.

SAVE THESE INSTRUCTIONS



INSTRUCTIONS

IMPORTANT SAFEGUARDS

When using electrical equipment, basic safety precautions should always be followed including the following:

1. **READ AND FOLLOW ALL SAFETY INSTRUCTIONS**
2. Disconnect power before performing work on electrical equipment.
3. Do not use outdoors.
4. Use caution when servicing batteries. Battery acid can cause burns to skin and eyes. If acid is spilled on skin or eyes, flush with fresh water and contact a physician immediately.
5. Equipment should be mounted in locations and at heights where unauthorized personnel will not readily subject it to tampering.
6. The use of accessory equipment not recommended by BeLuce Canada Inc. as it may cause an unsafe condition, and will void the unit's warranty.
7. Do not use this equipment for other than its intended purpose.
8. Servicing of this equipment should be performed by qualified service personnel.
9. **SAVE THESE INSTRUCTIONS!**

INSTALLATION

WALL MOUNT - SINGLE FACE:

1. Extend unswitched 24 hour AC supply of rated voltage to junction box or appropriate wiring (supplied by others). Leave at least eight (8) inches of slack wire. The circuit should not be energized at this time.
2. Remove the faceplate and sliding the pictogram out of if necessary (Figure 3).
3. Remove the universal canopy kit.
4. Knock out the appropriate mounting pattern and/or wire pass-thru hole on the sign back plate to fit the junction box.
5. Bring wires through the back of the sign, making connections inside the junction box, and mount the securely in place. Screw directly to junction box if possible.
6. Connect AC supply per diagram provided (Figure 5). **Insulate unused wire!**
CAUTION! - Failure to insulate unused wire may result in a shock hazard or unsafe condition as well as equipment failure.
7. Route wires and secure them in place.
8. Replace the faceplate
9. Turn on the AC voltage supply.

CEILING/END MOUNT - SINGLE OR DOUBLE FACE:

1. Follow steps 1 to 3 of Wall Mounting instructions above.
2. If double face is required then remove the backplate cover screw and slide the backplate down and out from frame. Signs that are specified double face will already have the second/rear faceplate installed.
3. On the top and side of the sign there are three (3) holes for the canopy - two (2) for the mounting screws and one (1) wire pass-thru hole. Knock out the three appropriate canopy mounting holes for your installation (Figure 3).
4. Secure the canopy to the sign using the supplied 1 inch screws and washer nuts and the snap wire pass-thru hole plastic bushing into the wire pass-thru hole in the centre of the canopy (Figure 2).
5. Bring wires through the wire pass-thru and connect AC supply as described in step 6 of Wall Mounting instructions above.
6. Secure the sign to the wall or ceiling using the supplied 1 1/2 inch screws and nuts. Screw directly to junction box if possible. A universal spider plate is supplied to allow for sign placement adjustment or connection to a variety of electrical boxes (Figure 4).
7. For double face signs install the second/rear faceplate.
8. Follow steps 6 to 9 of Wall Mounting instructions above.

Figure 1

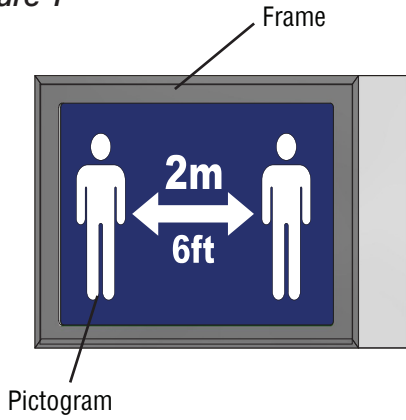

Figure 2

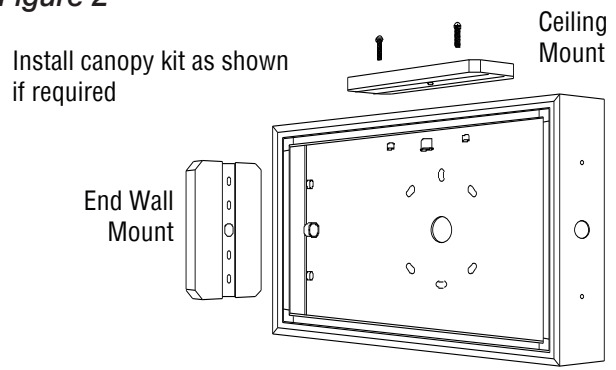

Figure 3

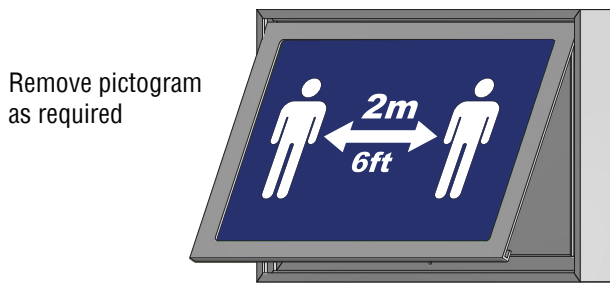

Figure 4

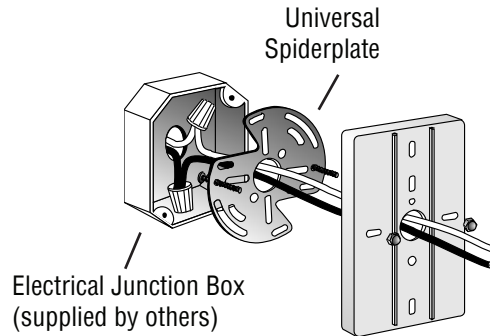
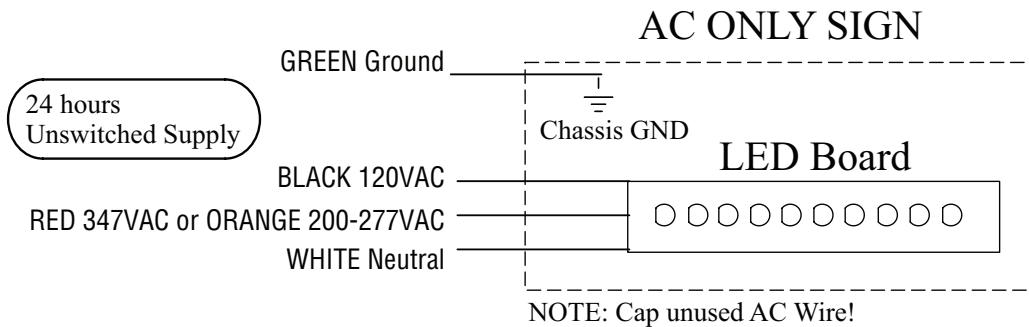

Figure 5



MAINTENANCE

- Code requires that the equipment be tested every 30 days for 30 seconds, and that written records be maintained. Further, the equipment is to be tested once a year for 90 minutes duration as per Code. The equipment is to be repaired whenever the equipment fails to operate as intended during the duration test. Written records of test results and any repairs made must be maintained. BeLuce Canada Inc. strongly recommends compliance with all Code requirements.
 - The lamps listed herein when used according to the instructions with this unit are in accordance with the requirements of CSA Standard C22.2, No. 141 – Unit Equipment for Emergency Lighting.
 - Clean sign face(s) on a regular basis.
- NOTE: The servicing of any parts should be performed by qualified service personnel only. The use of replacement parts not furnished by BeLuce Canada Inc., may cause equipment failure and will void the warranty.

SAVE THESE INSTRUCTIONS



INSTRUCTIONS

IMPORTANT SAFEGUARDS

When using electrical equipment, basic safety precautions should always be followed including the following:

1. **READ AND FOLLOW ALL SAFETY INSTRUCTIONS**
 2. Disconnect power before performing work on electrical equipment.
 3. Do not use outdoors.
 4. Use caution when servicing batteries.
 5. Equipment should be mounted in locations and at heights where unauthorized personnel will not readily subject it to tampering.
 6. The use of accessory equipment not recommended by BeLuce Canada Inc., may cause an unsafe condition, and will void the unit's warranty.
 7. Do not use this equipment for other than its intended purpose.
 8. Servicing of this equipment should be performed by qualified service personnel.
 9. **SAVE THESE INSTRUCTIONS!**
-

INSTALLATION

WALL MOUNT - SINGLE FACE:

1. Extend unswitched 24 hour AC supply of rated voltage to junction box or appropriate wiring (supplied by others). Leave at least eight (8) inches of slack wire. The circuit should not be energized at this time.
2. If a chevron is desired remove side panel with screw driver. Gently remove the red fibre and remove the chevron adhesive as desired. Reinsert the red fibre and secure the side of the exit back on with the screwdriver.
3. A wire pass-thru hole on the exit back plate is design to route the wires through the back of the sign (Figure 1)
4. Mount the exit securely in place. Screw directly to the junction box if possible. If not a spider plate (provided by other) may be used to connect the exit to the junction box (Figure 2)
5. Connect AC supply per diagram provided (Figure 3)
6. Ensure all wires are secured into place for a clean finished appearance (Figure 4)
7. Turn on the AC voltage supply

CEILING/END MOUNT - SINGLE OR DOUBLE FACE:

1. Extend unswitched 24 hour AC supply of rated voltage to junction box or appropriate wiring (supplied by others). Leave at least eight (8) inches of slack wire. The circuit should not be energized at this time.
2. If a chevron is desired remove side panel with screw driver. Gently remove the red fibre and remove the chevron adhesive as desired. Reinsert the red fibre and secure the side of the exit back on with the screwdriver.
3. Ceiling and end mount units are provided with a factory installed canopy which is not field adjustable.
4. Mount the exit securely in place. Screw directly to the junction box if possible. If not a universal spider plate may be used to connect the exit to the junction box for exit sign placement adjustment or connection to a variety of electrical boxes.
5. Exit signs that are specified double face will already have the second/rear faceplate installed.
6. Connect AC Supply per diagram provided (Figure 3)
7. Ensure all wires are secured into place for a clean finished appearance (Figure 4)
8. Turn on the AC voltage supply

SELF-POWERED:

1. For models MCE-SP, plug the battery into the circuit board per (Figure 3) self-powered sign.

Figure 1

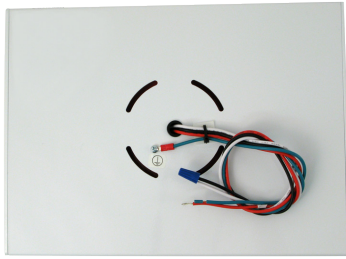

Figure 2

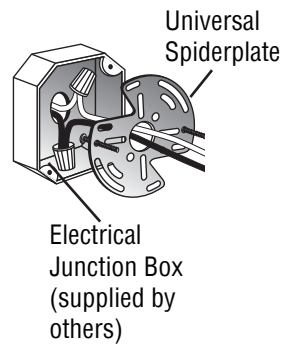

Figure 3

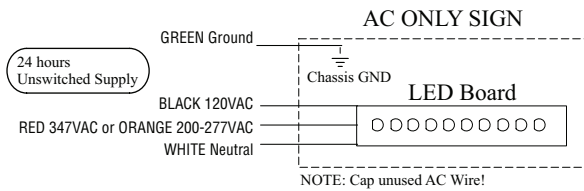

Figure 3



MAINTENANCE

1. The lamps listed herein when used according to the instructions with this unit are in accordance with the requirements of CSA Standard C22.2, No. 141 – Unit Equipment for Emergency Lighting.
 2. Clean lenses on a regular basis.
- NOTE: The servicing of any parts should be performed by qualified service personnel only. The use of replacement parts not furnished by BeLuce Canada Inc., may cause equipment failure and will void the warranty.

SAVE THESE INSTRUCTIONS

INSTRUCTIONS

IMPORTANT SAFEGUARDS

When using electrical equipment, basic safety precautions should always be followed including the following:

- 1. READ AND FOLLOW ALL SAFETY INSTRUCTIONS**
 2. Disconnect power before performing work on electrical equipment.
 3. Do not use outdoors.
 4. Use caution when servicing batteries. Battery acid can cause burns to skin and eyes. If acid is spilled on skin or eyes, flush with fresh water and contact a physician immediately.
 5. Equipment should be mounted in locations and at heights where unauthorized personnel will not readily subject it to tampering.
 6. The use of accessory equipment not recommended by BeLuce Canada Inc. as it may cause an unsafe condition, and will void the unit's warranty.
 7. Do not use this equipment for other than its intended purpose.
 8. Servicing of this equipment should be performed by qualified service personnel.
 - 9. SAVE THESE INSTRUCTIONS!**
-

INSTALLATION

WALL MOUNT - SINGLE FACE:

1. Extend unswitched 24 hour AC supply of rated voltage to junction box or appropriate wiring (supplied by others). Leave at least eight (8) inches of slack wire. The circuit should not be energized at this time.
2. Open the faceplate by removing screw from underside of faceplate (Figure 1). Tilt out the bottom of the faceplate, lift and remove (Figure 2).
3. Remove the universal canopy kit from inside the sign (if located there).
4. Knock out the appropriate mounting pattern and/or wire pass-thru hole on the back plate to fit the junction box or wiring connector being used (supplied by others).
5. Bring the wires through the back of the sign and mount the sign securely in place. Screw directly to the junction box if possible.
6. Connect AC supply per diagram provided (Figure 5). **Insulate unused wire!**
CAUTION! - Failure to insulate unused wire may result in a shock hazard or unsafe condition as well as equipment failure.
7. Route wires and secure them in place.
8. Position the pictogram between the posts on the inside of the faceplate and secure with 6 push nuts. (Figure 3)
9. Replace reflector inside housing (Figure 6).
10. Re-install faceplate and secure with screw.
11. Turn on the AC voltage supply.

CEILING/END MOUNT - SINGLE OR DOUBLE FACE:

1. Follow steps 1 to 4 of Wall Mounting instructions above.
2. On the top and side of the sign there are holes for the canopy. Knock out the appropriate canopy mounting holes for your installation.
3. Secure the canopy to the sign using the supplied nut and align the wire pass-thru hole in the frame to the wire pass-thru hole in the centre of the canopy.
4. Bring wires through the wire pass-thru and connect AC supply as described in step 6 of Wall Mount instructions above.
5. Secure the sign to the wall or ceiling using the supplied 1-1/2 inch screws and nuts. Screw directly to junction box if possible. A universal spider plate is supplied to allow for sign placement adjustment or connection to a variety of electrical boxes (Figure 4).
6. Follow steps 7 to 11 of Wall Mount instructions above.

Figure 1

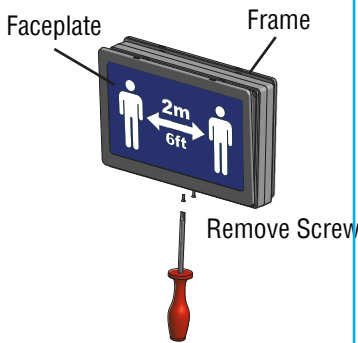

Figure 2



Figure 3

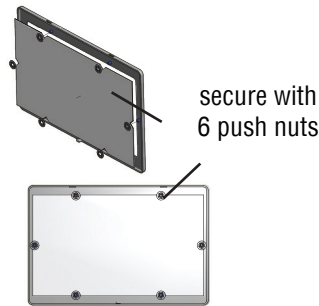

Figure 4

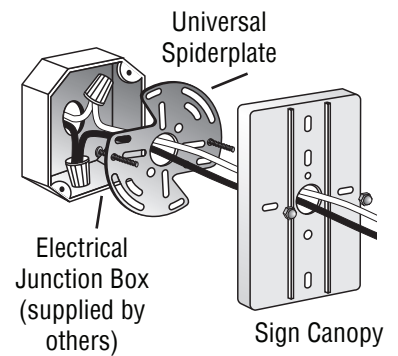

Figure 5

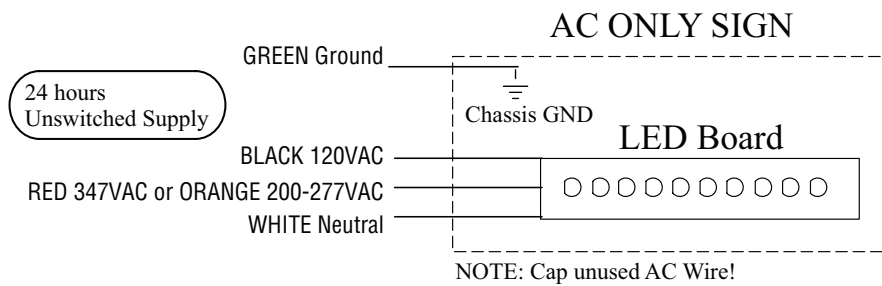
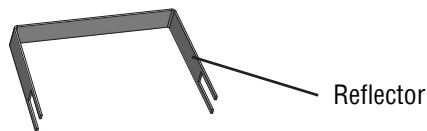

Figure 6



MAINTENANCE

1. Code requires that the equipment be tested every 30 days for 30 seconds, and that written records be maintained. Further, the equipment is to be tested once a year for the duration required as per Code. The equipment is to be repaired whenever the equipment fails to operate as intended during the duration test. Written records of test results and any repairs made must be maintained. BeLuce Canada Inc. strongly recommends compliance with all Code requirements.
2. Clean exit face(s) on a regular basis.

NOTE: The servicing of any parts should be performed by qualified service personnel only. The use of replacement parts not furnished by BeLuce Canada Inc., may cause equipment failure and will void the warranty.

TROUBLESHOOTING

EXIT SIGN DOES NOT COME ON AT ALL

1. Check AC supply and all AC connections - be sure exit has 24 hour AC supply (unswitched).
2. Check supply voltage and AC connections. The AC supply must be at least 80% of nominal (96V on a 120V line) for equipment to function normally. At lower voltages the LEDs will begin to glow dimly until the source voltage drops below the full "turn-on" point.

NOTE: This condition may also be caused by incorrectly connecting a 120 Volt supply line to the 277-Volt capacitor assembly lead.

3. AC supply is OK; replace LED circuit board assembly.

SAVE THESE INSTRUCTIONS

INSTRUCTIONS

IMPORTANT SAFEGUARDS

When using electrical equipment, basic safety precautions should always be followed including the following:

- 1. READ AND FOLLOW ALL SAFETY INSTRUCTIONS**
 2. Disconnect power before performing work on electrical equipment.
 3. Use caution when servicing batteries.
 4. Equipment should be mounted in locations and at heights where unauthorized personnel will not readily subject it to tampering.
 5. The use of accessory equipment not recommended by BeLuce Canada Inc., may cause an unsafe condition, and will void the unit's warranty.
 6. Do not use this equipment for other than its intended purpose.
 7. Servicing of this equipment should be performed by qualified service personnel.
 - 8. SAVE THESE INSTRUCTIONS!**
-

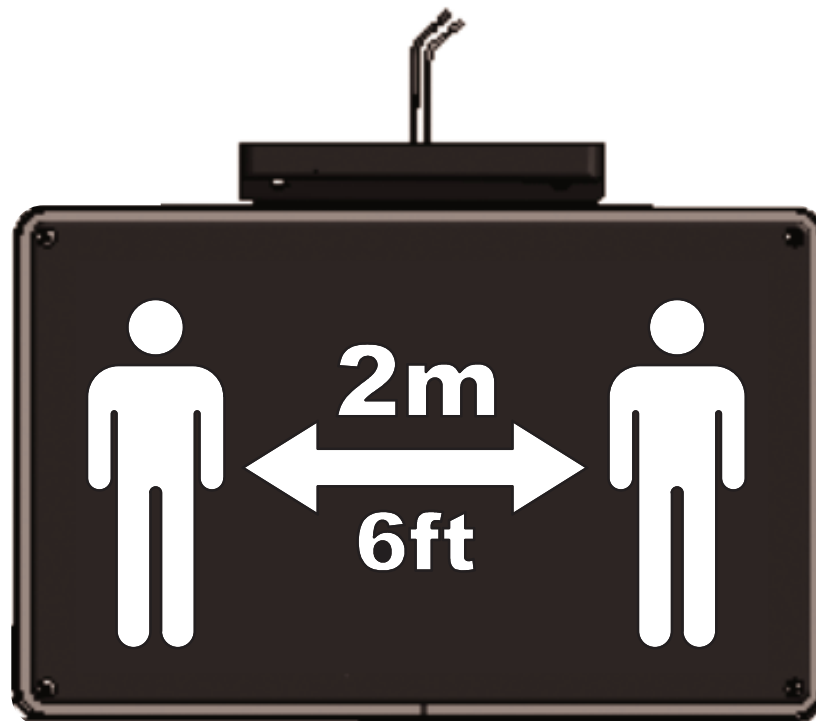
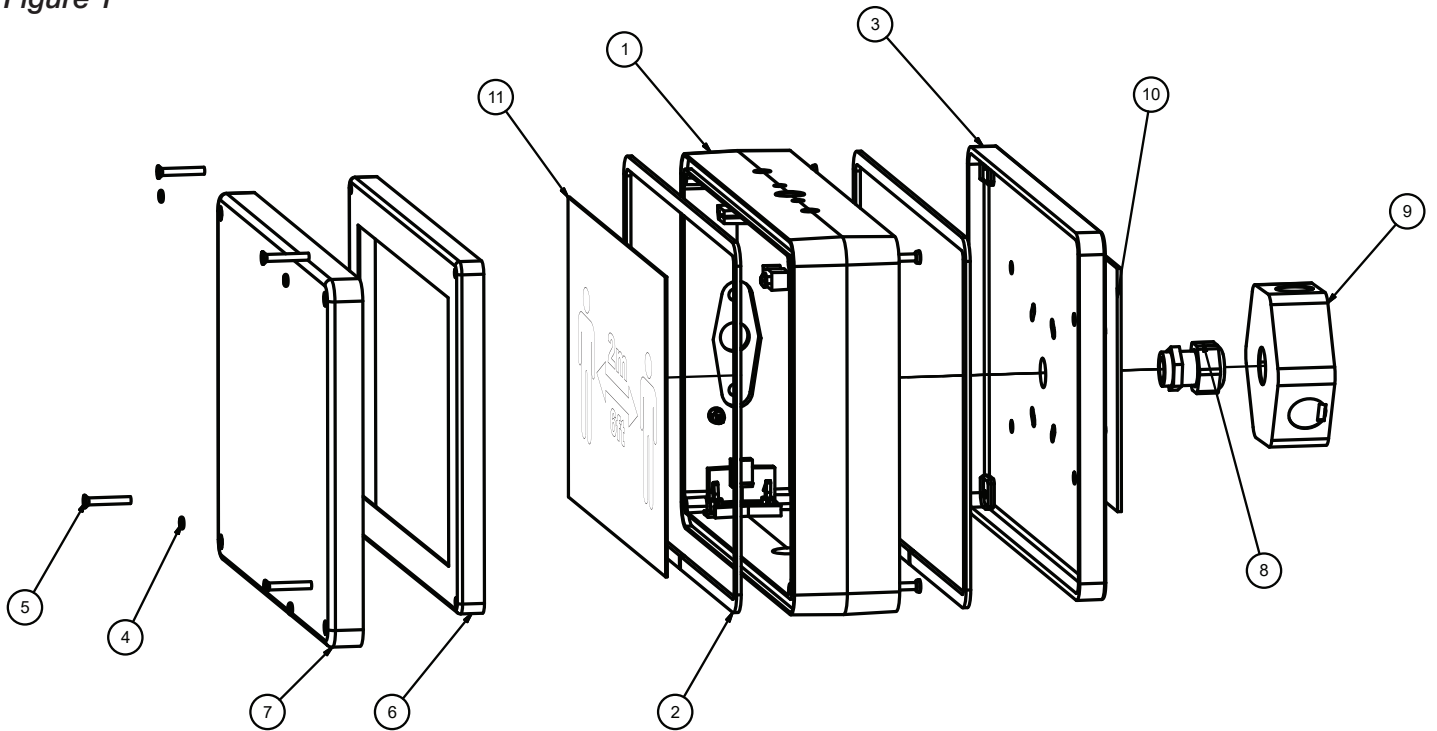

Figure 1



WALL MOUNT INSTALLATION:

1. Remove torx screws (5) to release clear lens (7). There are 4 O-rings (4) inserted to the clear cover screw holes. Release the open face frame (6) from the clear lens (7). Peel off backing paper from the tape on the back of the open face frame (6) and carefully position and stick the desired pictogram to the open face frame.
2. Remove the backplate (3) knockouts using applicable knockout holes. Install the liquid tight bushing into the large centre knockout with the lock nut (10). Feed the lead wires through the bushing and tighten to complete the liquid tight seal then secure the back plate and housing to the wall. Connect wire per wiring diagram provided. **Caution! Failure to insulate unused wire may result in a shock hazard or unsafe condition as well as equipment failure.**
3. Replace open face frame, clear lens and torx screws.
4. Apply power.

Parts List

1. Die-cast aluminum frame
2. Frame gasket
3. Die-cast backplate
4. O-ring
5. Torx tamper proof screws
6. Open face frame
7. Clear Lens
8. Bushing
9. Octagon Box
10. Mounting Gasket
11. Pictogram

Parts List

1. Die-cast aluminum frame
2. Frame gasket
3. Die-cast backplate
4. O-ring
5. Torx tramper proof screws
6. Open face frame
7. Clear lens
8. 1/4 - 20 hex socket cap screw
9. Canopy gasket
10. Canopy
11. Canopy base
12. Mounting screws
13. Bushing
14. Octagon box (not supplied)
15. Canopy gasket
16. Pictogram

CEILING/END MOUNT INSTALLATION

Figure 2

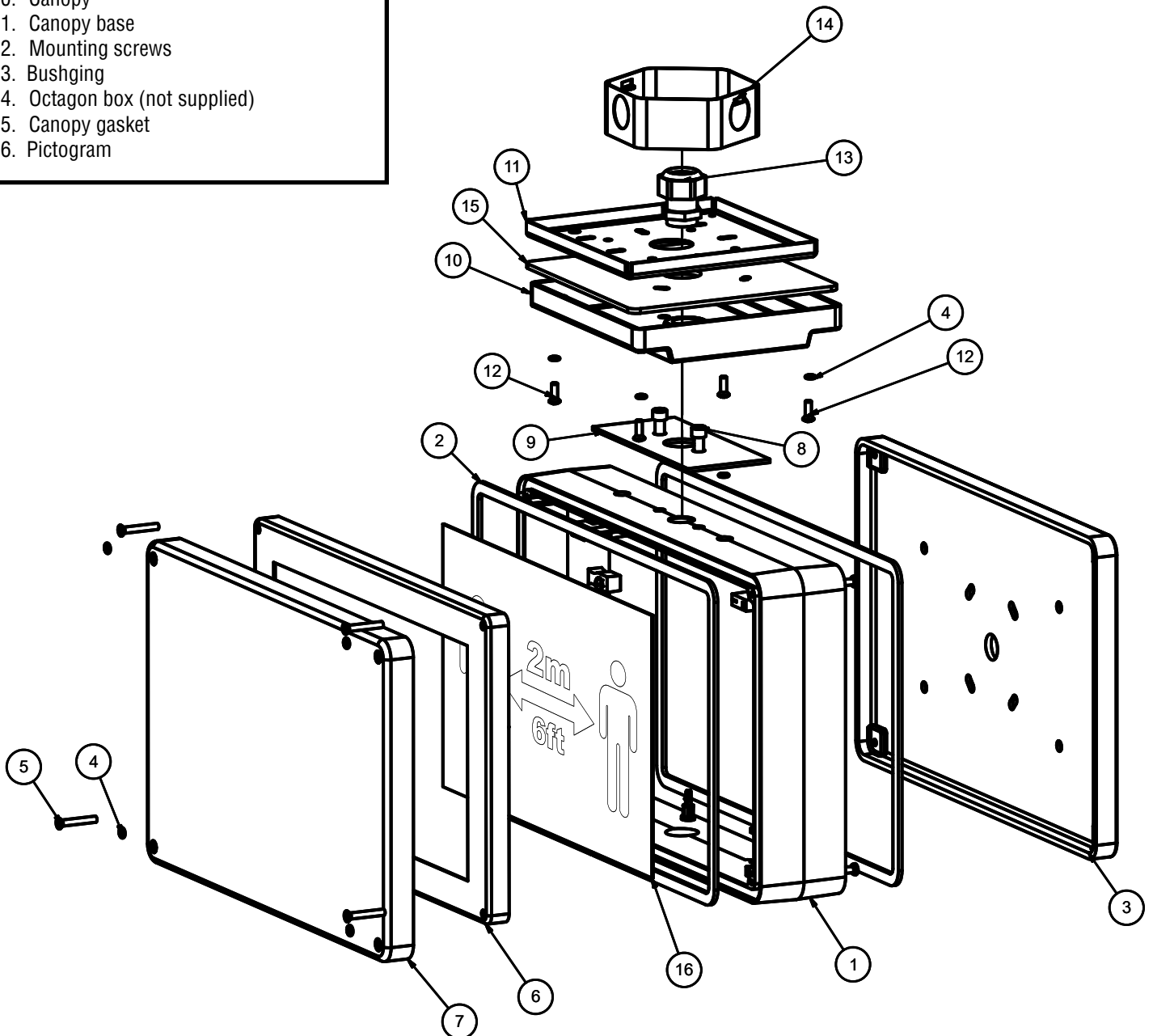

CEILING/END MOUNT INSTALLATION

1. Remove torx screws (1) to release clear lens (3). There are 4 O-rings (2) inserted to the clear lens screw holes. Release the open face frame (6) from the clear lens (3). Peel off backing paper from the tape on the back of the open face frame and carefully position and stick the desired pictogram to the open face frame.
2. To install canopy kit (13), 3 knockout on the top (for ceiling mount) or the 3 knockout on the side (for end mount). Position canopy gasket (19) and the canopy (20). Install the cap screws (22) and the washers (16). Attach canopy nuts (15) and then tighten. Install the liquid tight bushing. Install the canopy mounting base (23) to the octagon box (25) (not supplied). Connect wires per diagram provided.
Caution! Failure to insulate unused wire may result in a shock hazard or unsafe condition as well as equipment failure. The mounting base can be rotated for the desired mounting angle. Install the canopy (20) to the mounting base (23) with the supplied screws (18). Feed the lead wires through the bushing and tighten to complete the liquid tight seal.
3. Replace open face frame, clear lens and torx screws.
4. Apply power.

MAINTENANCE

The equipment is to be tested once a year in accordance with the code requirements. The equipment is to be repaired whenever the equipment fails to operate as intended during the duration test. Written records of test results and any repairs made must be maintained. BeLuce Canada Inc. strongly recommends compliance with these code requirements.

NOTE: The servicing of any parts should be performed by qualified service personnel only. The use of replacement parts not furnished by the manufacturer may cause equipment failure and will void the warranty.

WIRING DIAGRAM

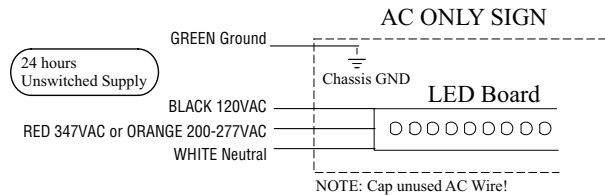

INSTRUCTIONS

IMPORTANT SAFEGUARDS

When using electrical equipment, basic safety precautions should always be followed including the following:

- 1. READ AND FOLLOW ALL SAFETY INSTRUCTIONS**
2. Disconnect power before performing work on electrical equipment.
3. Do not use outdoors.
4. Use caution when servicing batteries. Battery acid can cause burns to skin and eyes. If acid is spilled on skin or eyes, flush with fresh water and contact a physician immediately.
5. Equipment should be mounted in locations and at heights where unauthorized personnel will not readily subject it to tampering.
6. The use of accessory equipment not recommended by BeLuce Canada Inc. as it may cause an unsafe condition, and will void the unit's warranty.
7. Do not use this equipment for other than its intended purpose.
8. Servicing of this equipment should be performed by qualified service personnel.
- 9. SAVE THESE INSTRUCTIONS!**

INSTALLATION

1. Extend 24 hour AC supply of rated voltage (see product label) to an electrical box. Leave at least eight (8) inches of slack wire. The circuit should not be energized at this time - do not energize the AC supply until indicated.
2. Remove the cover/assembly by grasping the backbox and pulling the cover away to expose the two (2) tension springs (Figure 1). Unhook the springs from the tabs inside the backbox to remove the cover/assembly (Figure 2 & 3).
3. The sign may be either recessed wall or surface ceiling mounted. Remove the appropriate wire pass-thru hole from the back, top or end of the backbox enclosure. NOTE: Wall mounted fixtures have a faceplate with a 90 degree bend.
4. Use backbox the mark mounting position on wall or ceiling and cut hole for backbox.
5. Either attach the electrical box directly to the backbox or extend the AC supply to the backbox enclosure.
 - a) Direct Attachment: If attaching the electrical box directly, knockout the appropriate holes in the backbox, pass thru all wiring and then attached electrical box with appropriate screws (supplied by others).
 - b) Extend Wiring: If connecting the AC supply to a nearby electrical box, extend the wiring to the backbox and feed the supply circuit wiring through the wire pass hole. Use an approved connector to fasten the AC supply to the enclosure backbox.
6. Place the backbox enclosure into the final mounting position.
 - a) Install the two T-Bar adjusting brackets to the back box using the nuts and screw supplied.
 - b) Adjust the bracket position to compensate for ceiling thickness.Note: T-Bar is designed to span 24" tile width. Adjusting brackets can be installed either on the side or end of the back box to change orientation.
7. Secure the backbox into place.
8. Hold the cover/assembly upto the installed backbox and hook one of the tension springs into one of the internal tabs (Figure 2 & 3).
9. Connect AC supply per diagram provided (Figure 4). **Insulate unused wire!**
CAUTION! - Failure to insulate unused wire may result in a shock hazard or unsafe condition as well as equipment failure.
10. Hook the other tension spring into the remaining tab and push the assembly back up into the housing until secure.
11. Energize power to fixture. The LEDs board inside will light and the pictogram faceplate will now be illuminated.

MAINTENANCE

1. Code requires that the equipment be tested every 30 days for 30 seconds, and that written records be maintained. Further, the equipment is to be tested once a year for the required time duration. The the equipment is to be repaired whenever the equipment fails to operate as intended during the duration test. Written records of test results and any repairs made must be maintained. BeLuce Canada Inc. strongly recommends compliance with these code requirements.
2. The lamps listed herein when used according to the instructions with this unit are in accordance with the requirements of CSA Standard C22.2, No. 141 – Unit Equipment for Emergency Lighting.
3. Clean faceplates/lenses on a regular basis.

NOTE: Always turn off AC power before servicing. The servicing of any parts should be performed by qualified service personnel. The use of replacement parts not furnished by BeLuce Canada Inc., may cause equipment failure and will void the warranty.

Figure 1

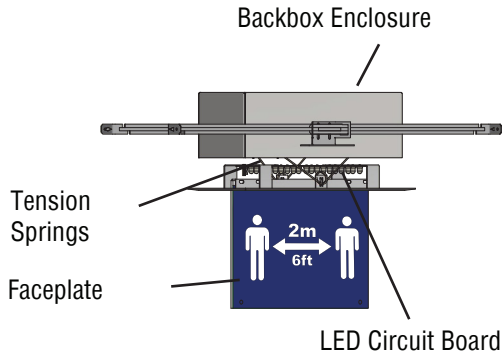

Figure 2

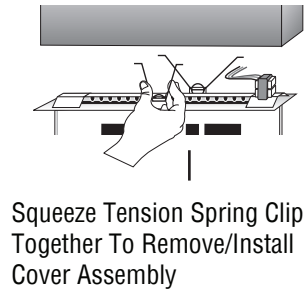

Figure 3

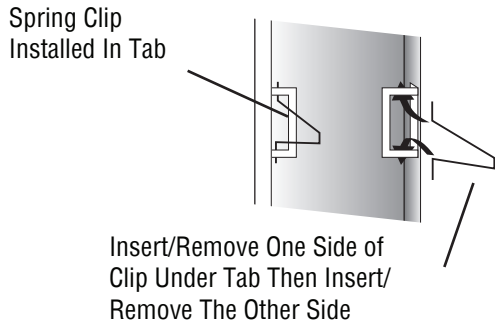

Figure 4

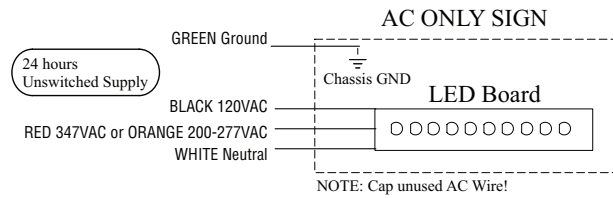

Figure 5

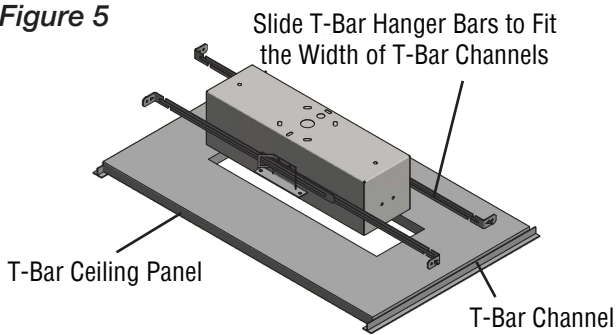

Figure 6

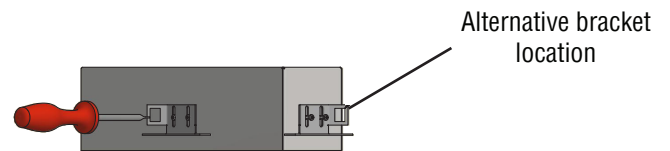

Figure 7

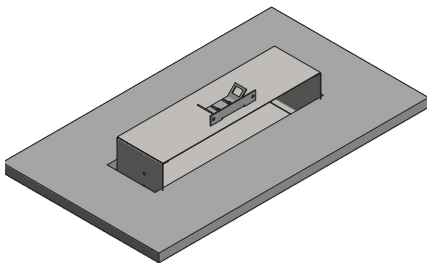
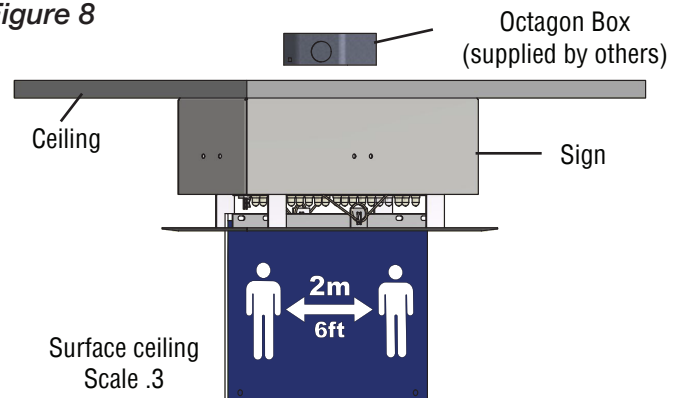

Figure 8



TROUBLESHOOTING

SIGN DOES NOT COME ON AT ALL

1. Check AC supply - be sure unit has 24 hour AC supply (unswitched).
2. AC supply is OK and indicator light is out, replace PC Board Assembly.
3. This could be the result of a switched AC supply to the unit (which has been turned off at some point).

SAVE THESE INSTRUCTIONS

INSTRUCTIONS

IMPORTANT SAFEGUARDS

When using electrical equipment, basic safety precautions should always be followed including the following:

- 1. READ AND FOLLOW ALL SAFETY INSTRUCTIONS**
 2. Disconnect power before performing work on electrical equipment.
 3. Do not use outdoors.
 4. Do not let power cords touch hot surfaces and do not mount near gas or electric heaters.
 5. Use caution when servicing batteries. Battery acid can cause burns to skin and eyes. If acid is spilled on skin or eyes, flush with fresh water and contact a physician immediately.
 6. Equipment should be mounted in locations and at heights where unauthorized personnel will not readily subject it to tampering.
 7. The use of accessory equipment not recommended by BeLuce Canada Inc. as it may cause an unsafe condition, and will void the unit's warranty.
 8. Do not use this equipment for other than its intended purpose.
 9. Servicing of this equipment should be performed by qualified service personnel.
 - 10. SAVE THESE INSTRUCTIONS!**
-

INSTALLATION

1. Extend 24 hour AC supply sign of rated voltage (see product label) to an electrical box installed in the location and orientation where the canopy can be mounted to it. Leave at least eight (8) inches of slack wire. The circuit should not be energized at this time - do not energize the AC supply until indicated.
2. Remove plastic bag surrounding sign and put on the plastic gloves located inside the bag before handling the sign directly (to protect against smudges and smears).

TO CHANGE PICTOGRAM (IF NECESSARY)

- a. Unscrew one end cap (Figure 2).
- b. Slide faceplate assembly out of cylinder (Figure 2).
- c. Remove buttons (Figure 11).
- d. Exchange pictogram.
- e. Reinstall buttons press together (Figure 12).
- f. Slide face into cylinder & screw on end cap.

WALL/CEILING MOUNTING

3. Internal wiring is already pulled into the canopy and all wires are labelled. Connect AC supply per diagram provided (Figure 3). Remove mounting plate from canopy and secure mount plate to junction box. **Insulate unused wire! CAUTION! - Failure to insulate unused wire may result in a shock hazard or unsafe condition as well as equipment failure.**
4. To change mounting type from ceiling mount to wall mount rotate canopy 90° (Figures 8, 9, 10).
5. Secure the sign to the mounting plate with two screws through the mounting holes in the canopy (Figures 4 & 5 ceiling/wall mounting) (Figures 6 & 7 end mounting).
6. Energize power to fixture.

END MOUNTING

7. Internal wiring is already pulled into the canopy and all wires are labelled. Connect AC supply per diagram provided (Figure 3). Remove mounting plate from canopy and secure mount plate to junction box. **Insulate unused wire! CAUTION! - Failure to insulate unused wire may result in a shock hazard or unsafe condition as well as equipment failure.**
8. Install spider plate to J box.
9. Secure sign to spider plate with two screws through mount holes in canopy.
10. Energize power to fixture.

Figure 1

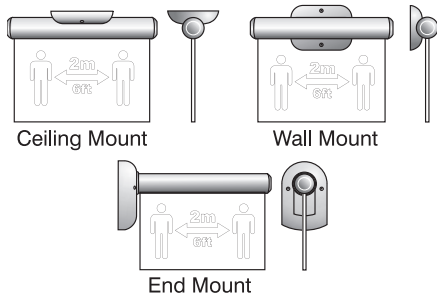

Figure 2

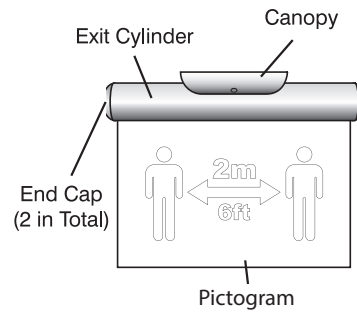

Figure 3

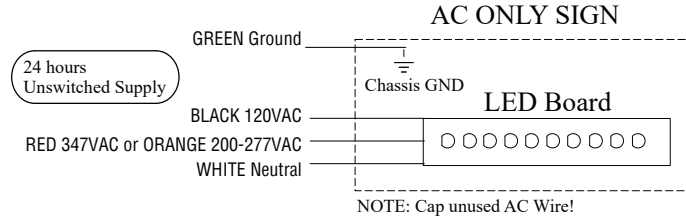

Figure 4

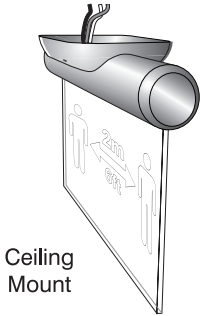

Figure 5

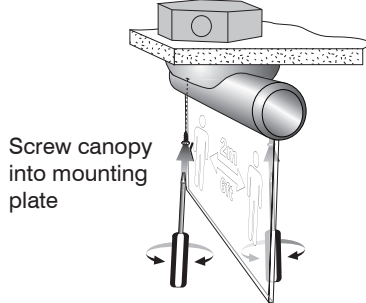

Figure 6

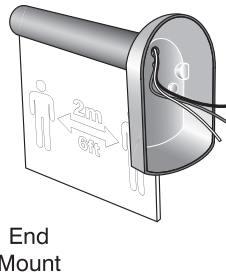

Figure 7

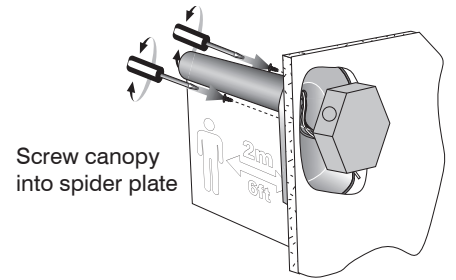

Figure 8

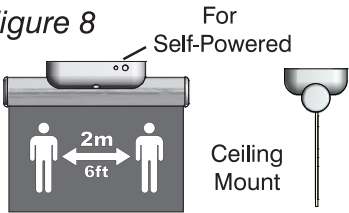

Figure 9

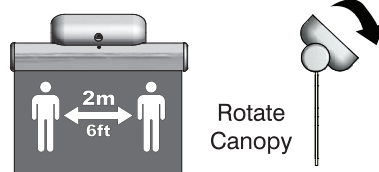

Figure 10



Figure 11

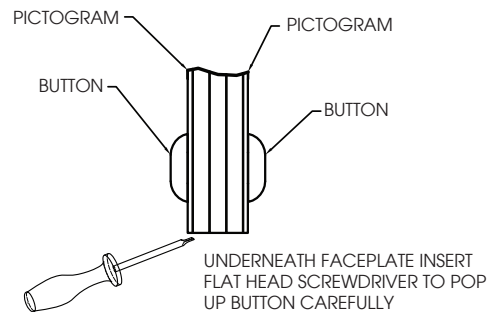
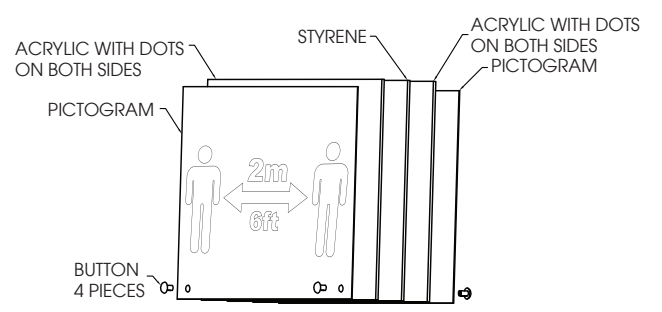

Figure 12



MAINTENANCE

1. BeLuce Canada Inc. strongly recommends testing and maintenance in compliance with all Code requirements.
2. The lamps listed herein when used according to the instructions with this unit are in accordance with the requirements of CSA Standard C22.2, No. 141 – Unit Equipment for Emergency Lighting.
3. Clean faceplates on a regular basis.

CAUTION: Always turn off AC power before servicing. The servicing of any parts, should be performed by qualified service personnel. The use of replacement parts not furnished by BeLuce Canada Inc. may cause equipment failure and will void the warranty.

TROUBLESHOOTING

SIGN DOES NOT COME ON AT ALL

- i. Check AC supply - be sure unit has 24 hour AC supply (unswitched).

SAVE THESE INSTRUCTIONS

INSTRUCTIONS IMPORTANT SAFEGUARDS

When using electrical equipment, basic safety precautions should always be followed including the following:

1. **READ AND FOLLOW ALL SAFETY INSTRUCTIONS**
2. Disconnect power before performing work on electrical equipment.
3. Do not use outdoors.
4. Use caution when servicing batteries. Battery acid can cause burns to skin and eyes. If acid is spilled on skin or eyes, flush with fresh water and contact a physician immediately.
5. Equipment should be mounted in locations and at heights where unauthorized personnel will not readily subject it to tampering.
6. The use of accessory equipment not recommended by BeLuce Canada Inc. as it may cause an unsafe condition, and will void the unit's warranty.
7. Do not use this equipment for other than its intended purpose.
8. Servicing of this equipment should be performed by qualified service personnel.
9. **SAVE THESE INSTRUCTIONS!**

First, complete **A Common Mounting Steps** (page 2) before proceeding to mounting options shown below.

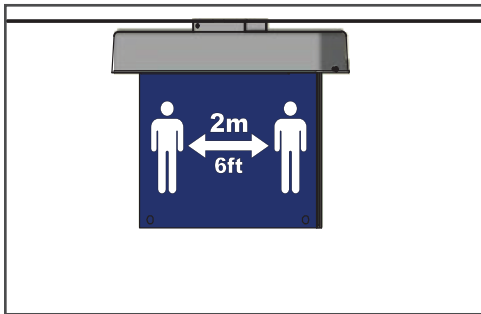

Surface Ceiling Mounting,
See page 3

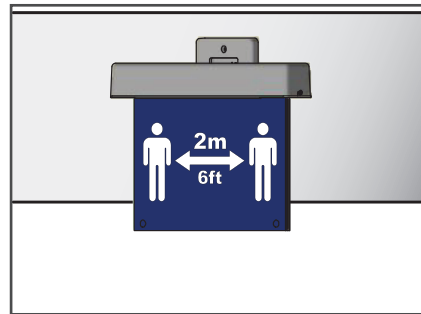

Surface Wall Mounting,
See page 3

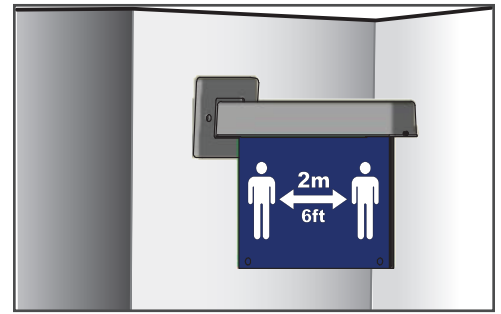

Surface End Mounting,
See page 4

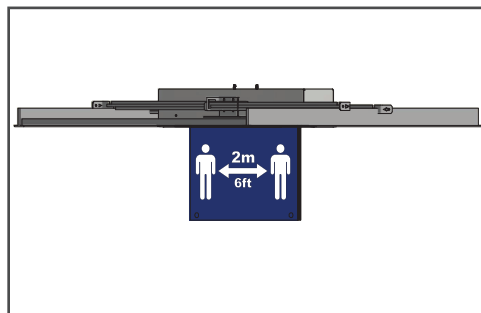

T-Bar Mounting,
See page 5

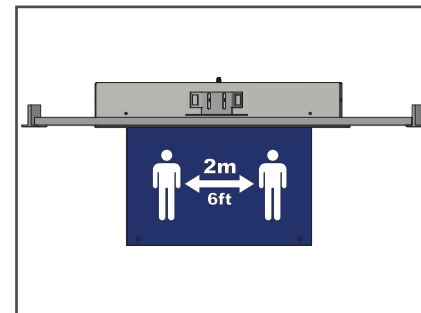

Ceiling Recessed Mounting,
See page 6

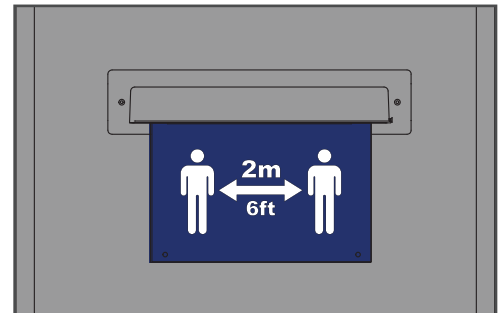

Wall Recessed Mounting,
See page 6

Components

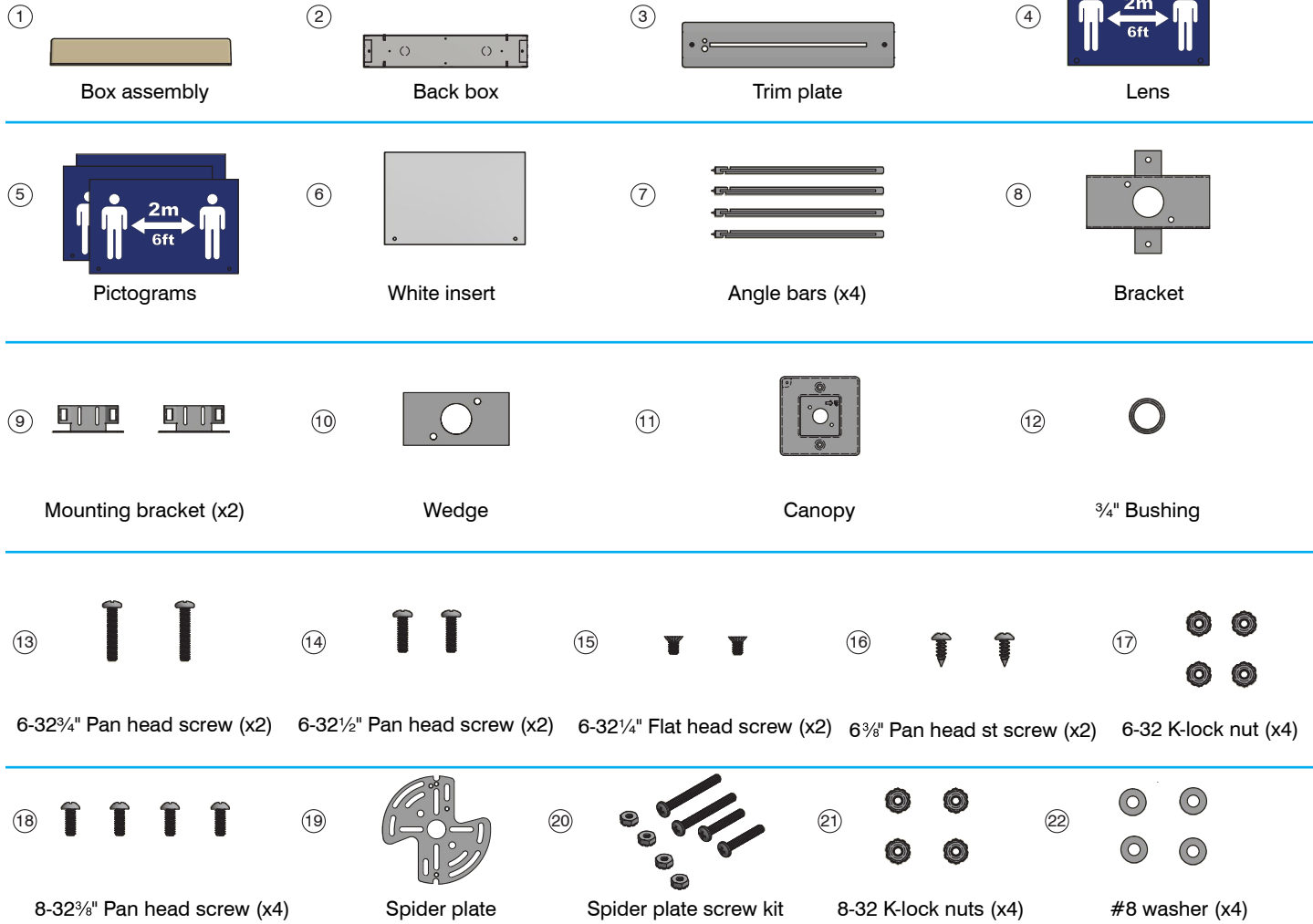

INSTALLATION

A Common Mounting Steps:

1. Remove cover from box assembly ① by removing screw on end of box assembly.

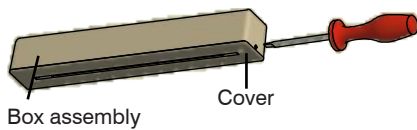

2. Knock out appropriate holes for mounting and install 3/4" bushing ⑫ in entry hole and feed wires through.

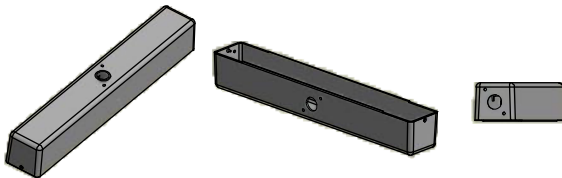

3. For t-bar or ceiling recessed, knock out top holes.
 4. For ceiling, knock out top, for surface end, knock out end, for surface wall, knock out side.

5. ⚠ Remove protective sleeve from LED strip.

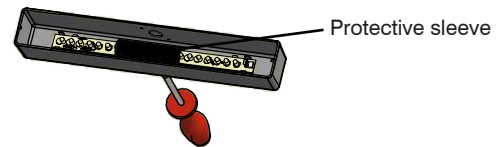

6. Select pictogram. Install white insert ⑥ or pictogram ⑤.

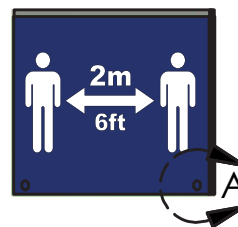

Underneath pictogram, insert flat head screwdriver to pop up button carefully

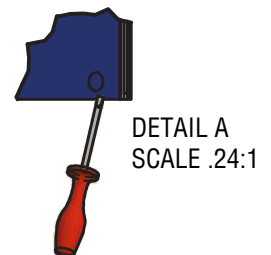

7. Slide lens assembly into cover 1 ○.

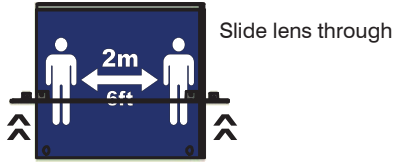

8. Secure using two 3/4" pan head screws ③ and k-lock nuts ⑦ 1.

Surface Ceiling Mounting:

1. Install canopy 11 ○ to box using two 1/2" pan head screws ④ and k-lock nuts ⑦.

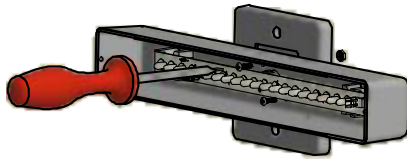

3. Secure with screw.

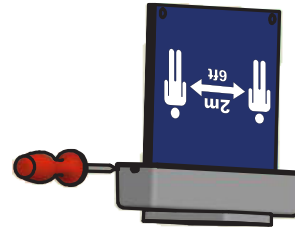

2. Install cover and lens assembly into box.

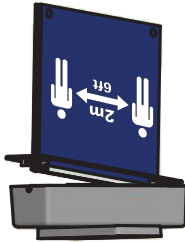

4. Thread wires through the spider plate. ⑱

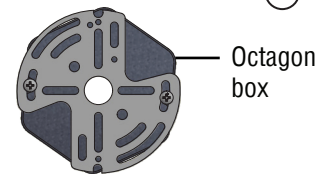

5. Make electrical connections (see **Wiring Diagram**, page 6).

6. Adjust the orientation of the spider plate to proper position. ⑳

Surface Wall Mounting:

1. Position wedge 1 ○ and canopy with the thick side of wedge up.

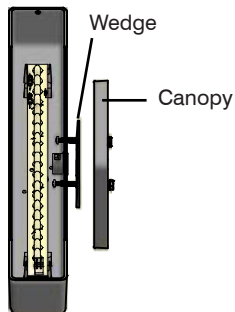

4. Secure with screw.

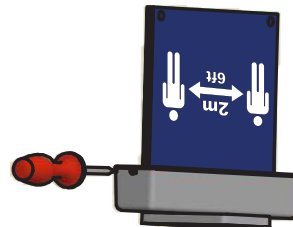

2. Secure with two 1/2" pan head screws ④ and k-lock nuts ⑦.

5. Thread wires through the spider plate. ⑱

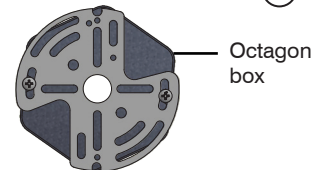

⑦ 3. Install cover and lens assembly into box.

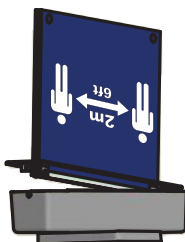

6. Make electrical connections (see **Wiring Diagram**, page 6).

7. Adjust the orientation of the spider plate to proper position. ⑳

Surface End Mounting:

1. Position canopy 11 .
2. Secure with two 1/2" pan head screws 1  and k-lock nuts

NOTE:
orientation
of canopy
"up".

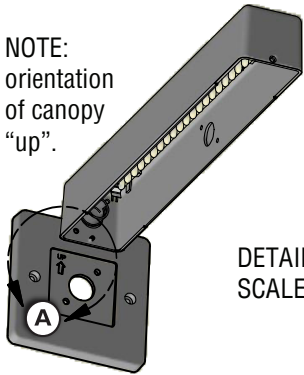

DETAIL A
SCALE .4

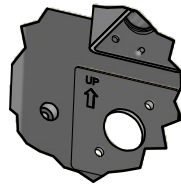

3. Install cover and lens assembly into box.
4. Secure with screw.

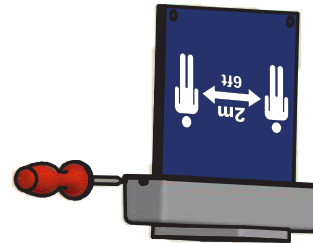

7.

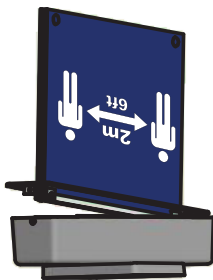

5. Thread wires through the spider plate. 

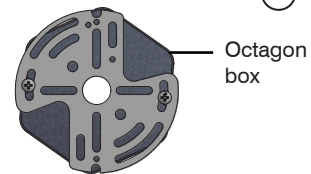



6. Make electrical connections (see **Wiring Diagram**, page 6).
7. Adjust the orientation of the spider plate to proper position.

NOTE: Follow steps 1 through 8 in **A** Common Mounting Steps before proceeding onto **B** Common Steps for Recessed Mounting.

B Common Steps for Recessed Mounting:

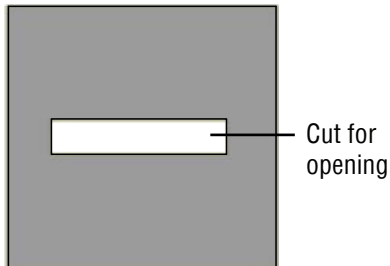
1. Use back box  as template cut opening.



2. Knock out entry hole in back box .

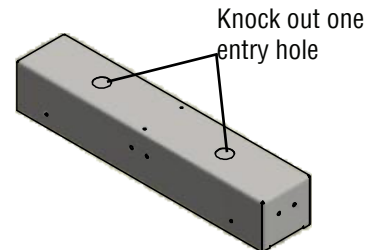

3. Install strain-relief (not supplied).

T-Bar Mounting:

1. Install two mounting brackets (9) to back box (2) using four 3/8" pan head screws (8), washer (22), and K-lock nuts (21).

NOTE: Mounting brackets can be installed on sides or ends of

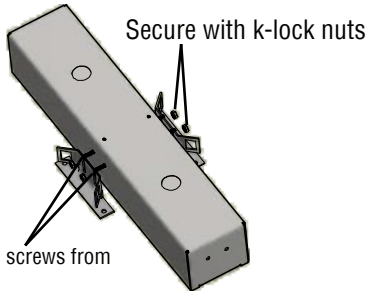

backbox.

2. Slide four angle bars into mounting brackets (9).

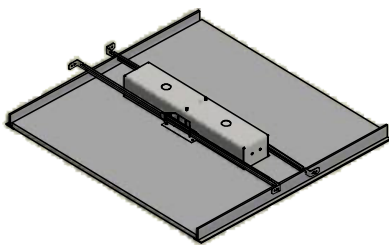

3. Install backbox assembly in ceiling.
4. Install bracket (8) to top of box assembly (1) using two 1/2"

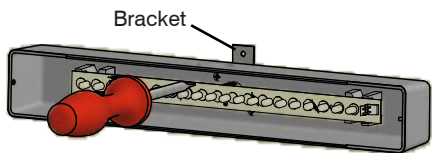

pan head screws (4) and k-lock nuts (7).

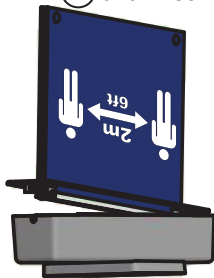

5. Install cover and lens assembly into box.

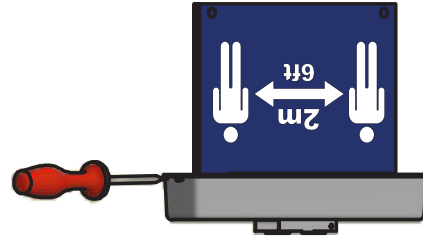

6. Secure with screw.
7. Make electrical connections (see **Wiring Diagram**, page 6).
8. Position assembly up into back box (2) and secure bracket (8)

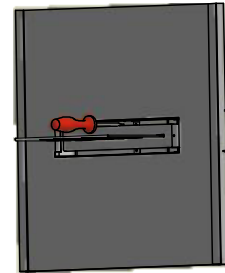

9. Slide trim plate (3) over lens and secure with 7/6" flat head screws (5).

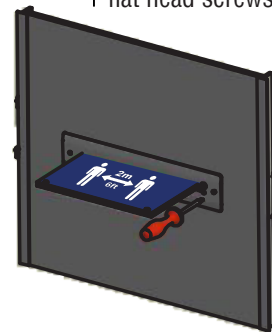

Ceiling Recessed Mounting:

For Ceiling Recessed Mounting, follow **T-Bar Mounting** instructions and exclude angle bars (7).

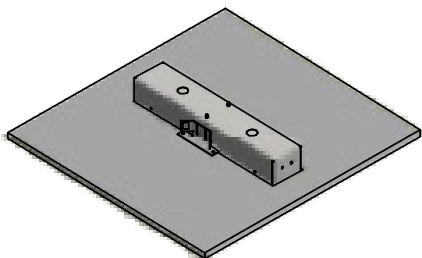

Wall Recessed Mounting:

1. Drill out three holes on trim plate (3). Use marks on trim plate $\frac{7}{8}$ " diameter mounting holes and two $\frac{3}{16}$ " diameter mounting holes.

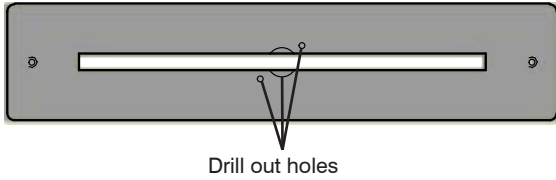

2. Position wedge (4) and trim plate (3) with thick side of wedge up.

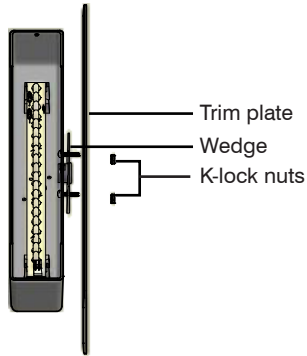

3. Secure with two $\frac{3}{8}$ " pan head screws (5) and k-lock nuts

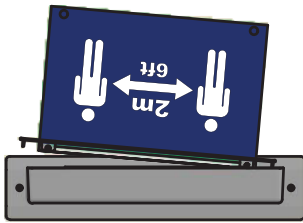

(7)

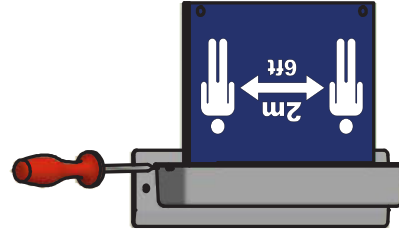

4. Install cover lens assembly into box.
5. Secure with screw.
6. Make electrical connections (see **Wiring Diagram**, page 6).
7. Position assembly to back box (2) and secure using $\frac{7}{6}$ " flat head screws (5) 1.

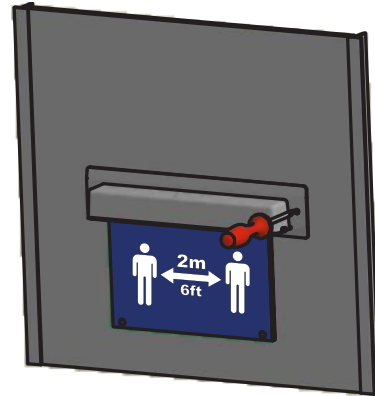

Wiring Diagram

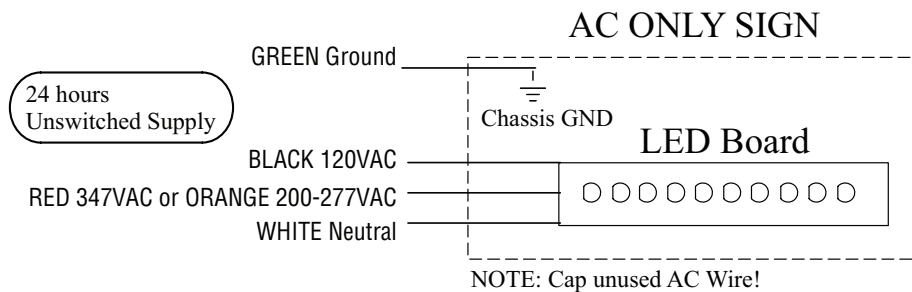

MAINTENANCE

1. Code requires that the equipment be tested every 30 days for 30 seconds, and that written records be maintained. Further, the equipment is to be tested once a year for the required time duration. The the equipment is to be repaired whenever the equipment fails to operate as intended during the duration test. Written records of test results and any repairs made must be maintained. BeLuce Canada Inc. strongly recommends compliance with these code requirements.
2. The lamps listed herein when used according to the instructions with this unit are in accordance with the requirements of CSA Standard C22.2, No. 141 – Unit Equipment for Emergency Lighting.
3. Clean faceplates/lenses on a regular basis.
NOTE: Always turn off AC power before servicing. The servicing of any parts should be performed by qualified service personnel. The use of replacement parts not furnished by BeLuce Canada Inc., may cause equipment failure and will void the warranty.

TROUBLESHOOTING

EXIT SIGN DOES NOT COME ON AT ALL

1. Check AC supply - be sure unit has 24 hour AC supply (unswitched).
2. AC supply is OK and indicator light is out, replace PC Board Assembly.
3. This could be the result of a switched AC supply to the unit (which has been turned off at some point).

SAVE THESE INSTRUCTIONS