

PLANEX BACKLIT & PLANEX BACKLIT PREMIUM

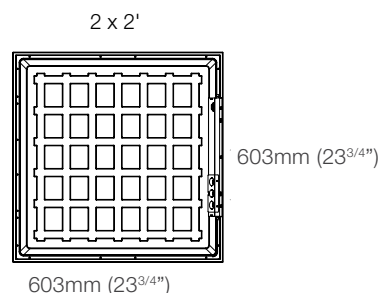

MODEL INFORMATION

MODEL	LED BACKLIT PANEL
WATTAGE	20W-50W
VOLTAGE	120-347V
WET LOCATION	YES
OPERATION	0-10 V dimming standard
COLOUR TEMPERATURE	3500K, 4000K, 5000K

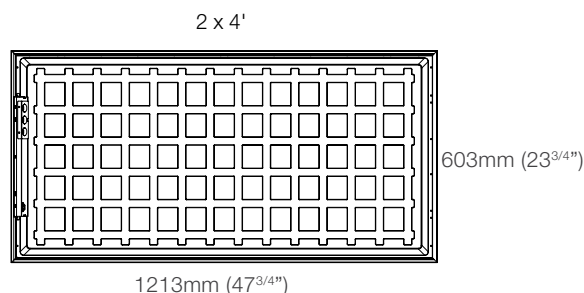
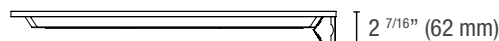
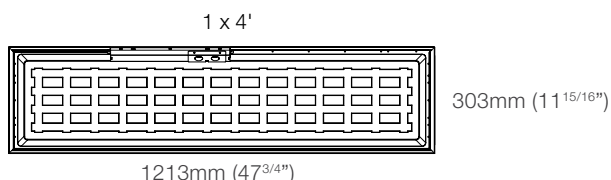

WARNING ELECTRICAL SHOCK HAZARD

READ and UNDERSTAND these instructions before installing the luminaire.

Disconnect the Electrical supply power at the services panel (fuse or circuit breaker box). Failure to do so could result in serious injury.

Only qualified electricians should install this luminaire and the installation **MUST** conform to the Canadian Electrical Code Part I, NEC and any local codes and ordinances. Any change or modifications not expressly approved by the party responsible for compliance could void the authority to operate the equipment. Make sure you have the proper tools and materials to complete the installation before attempting to install the luminaire.

SAVE THESE INSTRUCTIONS!

WARNING

No user serviceable parts. Refer service to a qualified service technician. Read instructions prior to installing and/or operating this device. Installation should be performed by a licensed electrician/installer in accordance with local codes.

SUSPENDED HORIZONTAL MOUNT (Fig. 1)

1. Select the appropriate LED color temperature and power by using the wiring box switches when applicable (Detail A).
2. Install the aircraft cable couplings kits into the ceiling by using the luminaire as a drill pattern (Detail B).
3. Attach the carabiners' aircraft cables on the earthquake-proof hooks of the luminaire (Detail C).
4. Open the luminaire wiring box by unscrewing the retaining screw. Install the power cable.
5. Make wires connection (Fig. 4) inside the wiring box, (wire nuts not included). Observe the polarity of the GROUND wire, connected to the supplier grounding conductor, the line wire to the PHASE conductor and the neutral wire to the NEUTRAL conductor.

For the Dimming Circuit connect purple lead to "+" lead and the grey lead to "-" lead.

IMPORTANT: Check the compatibility of the wires (gauge, insulation, and voltage) with the connectors of the wiring box before proceeding.

WARNING! Push connected wires into the wiring box with caution. Close the wiring box.

6. Balance the luminaire by using the aircraft cable couplings (Detail D). Adjust the length and cut the extra cable at the end.
7. Apply power.

SUSPENDED HORIZONTAL MOUNT

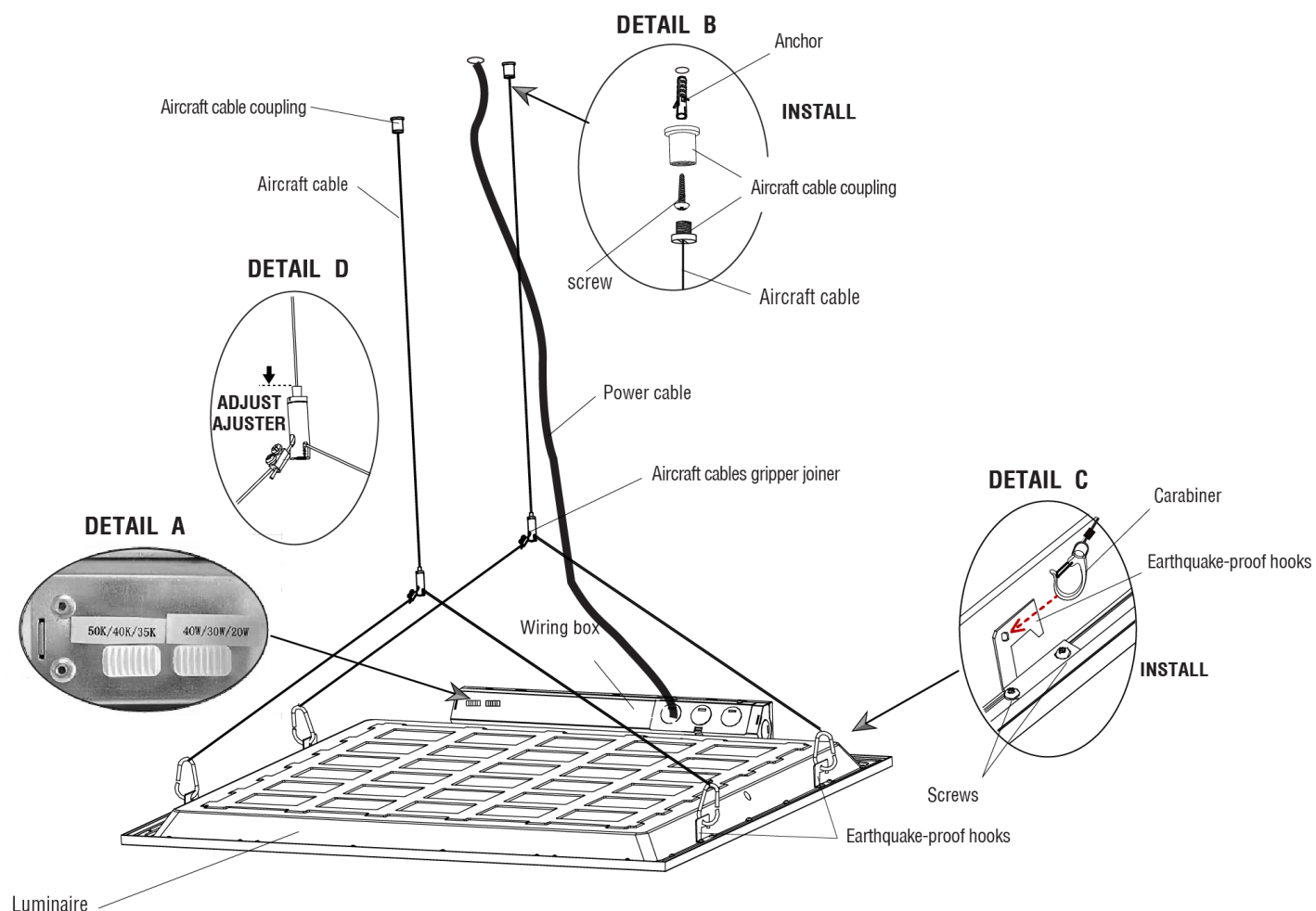

RECESSED MOUNT (Fig. 2)

1. Extend a supply of rated voltage near the unit using a BX cable. This circuit should NOT be energized/live at this time.
2. Select the appropriate LED color temperature and power by using the wiring box switches when applicable.
3. The unit has T-bar earthquake-proof hooks located on each side that align the unit onto the T-bar grid and secure it. Bend each earthquake-proof hook (see detail Fig. 2) and mount the unit on the ceiling securely in place (Fig. 2).
4. Open the luminaire wiring box by unscrewing the retaining screw.
5. Install the BX cable to the wiring box of the panel light.
6. Make wires connection (Fig. 4) inside the wiring box, (wire nuts not included). Observe the polarity of the GROUND wire, connected to the supplier grounding conductor, the line wire to the PHASE conductor and the neutral wire to the NEUTRAL conductor.

For the Dimming Circuit (if available) connect purple lead to “+” lead and the grey lead to “-” lead.

IMPORTANT: Check the compatibility of the wires (gauge, insulation, and voltage) with the connectors of the wiring box before proceeding.

WARNING! Push connected wires into the wiring box with caution. Close the wiring box.

7. Apply power.

RECESSED MOUNT

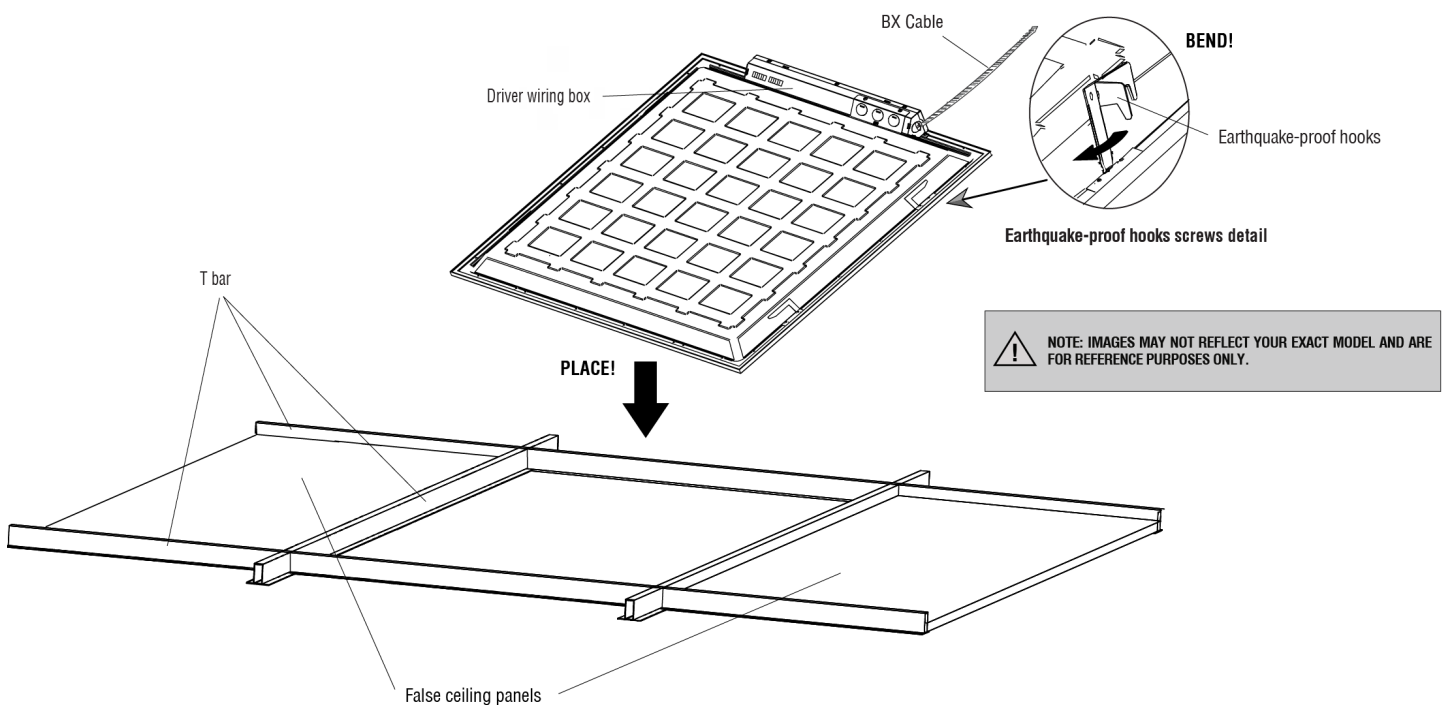

SURFACE MOUNT (OPTIONAL - Fig. 3)

1. Install the frame using the mounting screws (Fig. 3A).
2. Use the frame as a drilling template (Fig. 3B) and make the holes for the anchor system in the ceiling.
3. Fix the frame on the ceiling using the mounting kit (Fig. 3B).
4. Remove the frame's lateral plate using the four (4) screws (Fig. 3B).
5. Select the appropriate LED color temperature and power by using the luminaire wiring box switches when applicable.
6. Open the luminaire wiring box by unscrewing the retaining screw.
7. Install the BX cable to the wiring box of the panel light. The BX cable must be previously installed and connected to a ceiling recessed junction box.

NOTE: Allow enough length of BX cable in order to perform the installation with the wiring box panel light before sliding it into the frame.

8. Make wires connection (Fig. 4) inside the wiring box, (wire nuts not included). Observe the polarity of the GROUND wire, connected to the supplier grounding conductor, the line wire to the PHASE conductor and the neutral wire to the NEUTRAL conductor.

For the Dimming Circuit (if available) connect purple lead to "+" lead and the grey lead to "-" lead.

IMPORTANT: Check the compatibility of the wires (gauge, insulation, and voltage) with the connectors of the wiring box before proceeding.

WARNING! Push connected wires into the wiring box with caution. Close the wiring box.

9. Close the wiring box.
10. Slide the panel light LED into the mounting frame as shown in Fig. 3C.
11. Close the frame of the fixture with the lateral plate using four screws (Fig. 3D).
12. Apply power.

x

SURFACE MOUNT (OPTIONAL)

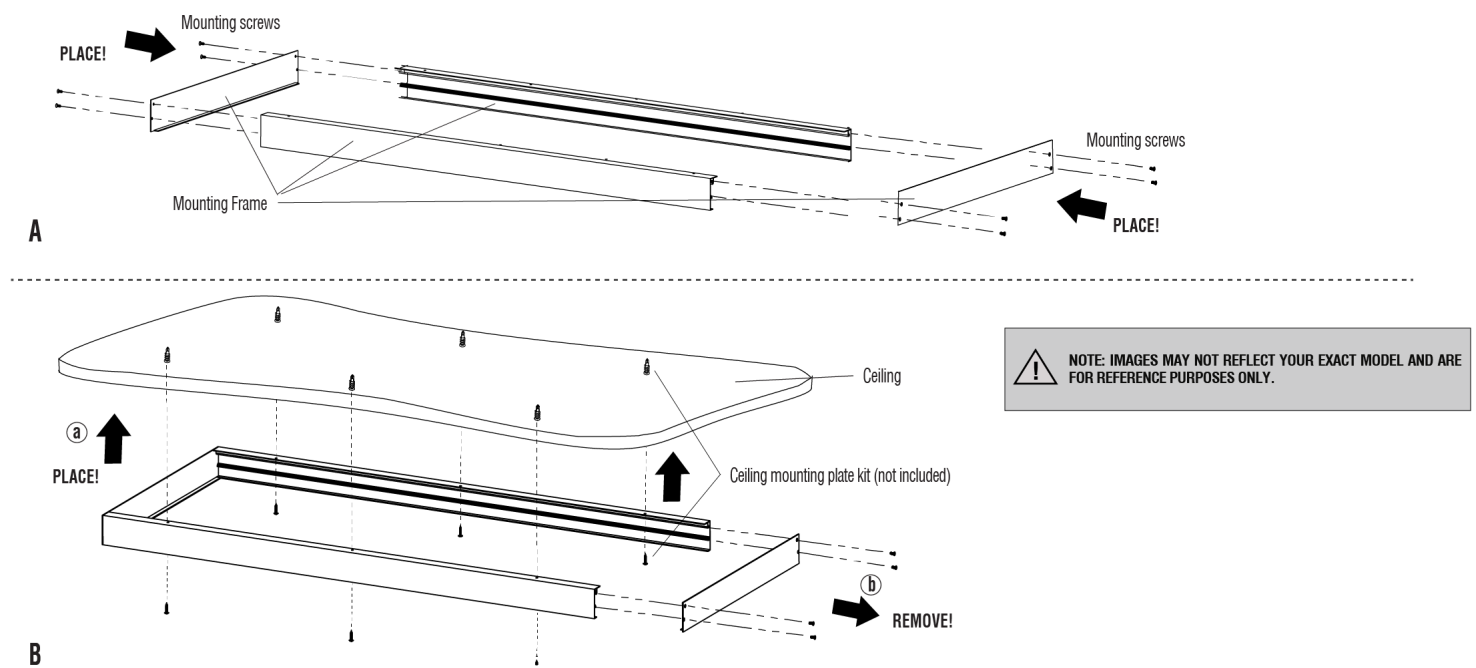

SURFACE MOUNT (OPTIONAL)

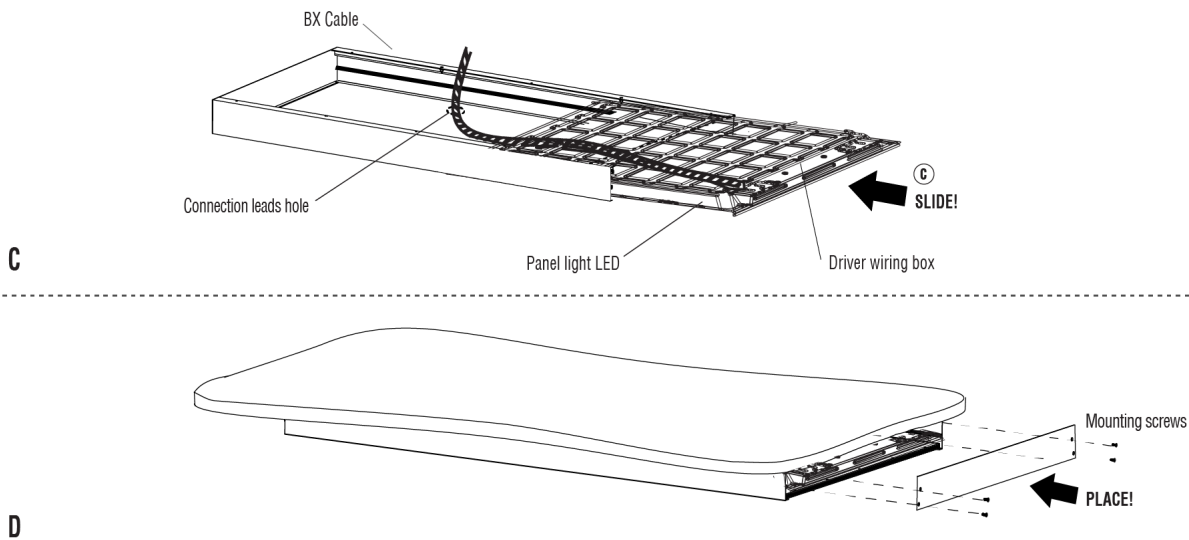

4 WIRING DIAGRAM

