



OTTICA ECO RM (OT-ECO-RM)

INSTRUCTIONS IMPORTANT SAFEGUARDS

When using electrical equipment, basic safety precautions should always be followed including the following:

- 1. READ AND FOLLOW ALL SAFETY INSTRUCTIONS**
2. Disconnect power before performing work on electrical equipment.
3. Do not use outdoors.
4. Do not let power cords touch hot surfaces and do not mount near gas or electric heaters.
5. Use caution when servicing batteries. Battery acid can cause burns to skin and eyes. If acid is spilled on skin or eyes, flush with fresh water and contact a physician immediately.
6. Equipment should be mounted in locations and at heights where unauthorized personnel will not readily subject it to tampering.
7. The use of accessory equipment not recommended by BeLuce Canada Inc., may cause an unsafe condition, and will void the unit's warranty.
8. Do not use this equipment for other than its intended purpose.
9. Servicing of this equipment should be performed by qualified service personnel.
10. Allow battery to charge for 24 hours before first use.
- 11. SAVE THESE INSTRUCTIONS!**

Use Flexible Conduit Only

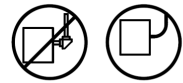

INSTALLATION

CEILING MOUNTING:

1. Open the EXIT housing and diffuser with a screwdriver (figure 1).
2. Twist off the cap on one side of the fixture (figure 2).
3. Knockout in back of mounting plate and push wires through the hole (figure 3).
4. Insert correct pictogram from the surface of the panel by bending the sheet (figure 5).
5. Make the proper supply lead connections (figures 3 & 4).

NOTE: If using 120VAC, connect the black and white leads to the building utility. If using 347VAC, connect the red and white leads to the building utility. If using 277VAC, connect the orange and white leads to the building utility. Cap off unused wires separately. If the unit is self-powered, be sure to plug the battery into the charger board. If using DC, red is positive (+), white is negative (-).

6. Insert the exit sign board and restore the cap (figure 6).
7. If the unit is self-powered when the test button is pushed the sign LED will come on and the AC light will turn off.

WALL MOUNTING:

1. Follow 1-7 step of ceiling mounting.
2. Rotate the exit sign board by 90 degree for wall mounting (figure 7).

CEILING MOUNTING

Figure 1

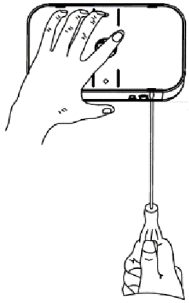

Figure 2

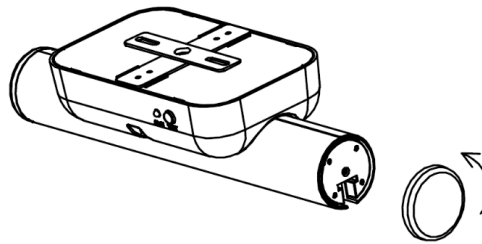

Figure 3

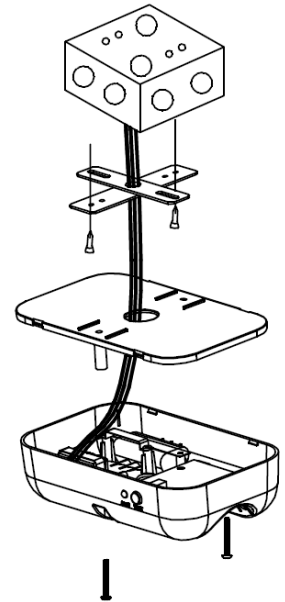

Figure 4

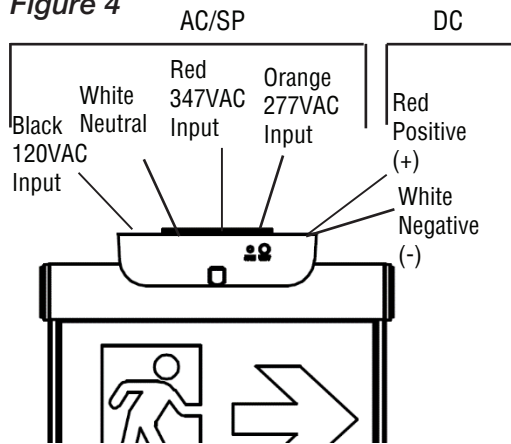

Figure 5

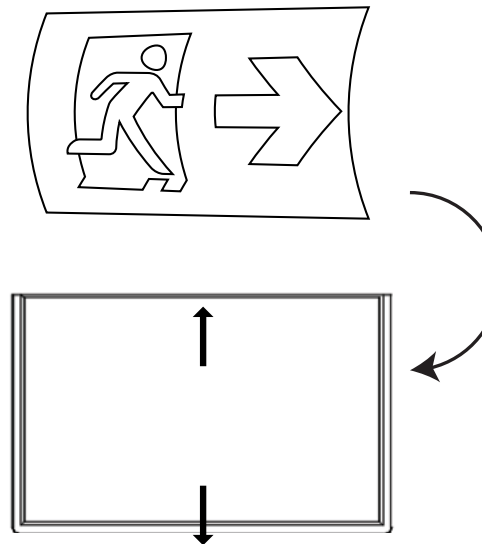
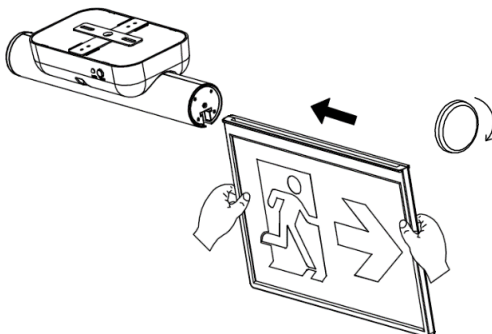

Figure 6



WALL MOUNTING

Figure 7

